

Architect:

Community Design Studio, LLC
930 Cambria Street, NE
Christiansburg, VA 34073
Phone: (804)382-2002
Fax: (804)382-1935
communityhousingpartners.org

Owner:

Community Housing Partners

Project Cost:

\$2,645,000

Square Footage:

16,100 sf

Cost per Square Foot:

\$80/sf

Completion Date:

October 2006

Consultants:

Gay and Neel, Inc.
2RW Consultants, Inc.

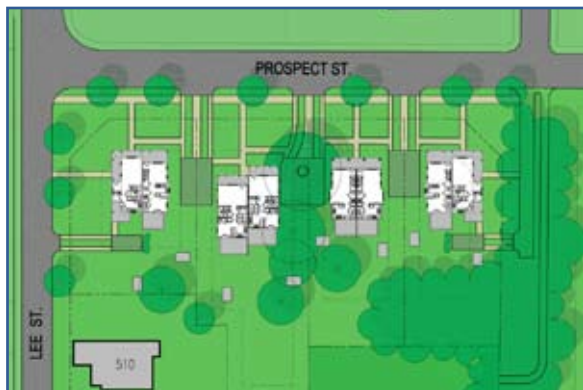

Project Description:

Situated in Virginia Tech's backyard in the Blue Ridge Mountains, this development consists of seven duplex buildings situated in the historic Roanoke-Lee Street neighborhood. As an example of green, affordable housing, the fourteen duplex units were designed and constructed utilizing efficient design, sustainable materials and incorporating energy efficient features throughout. Each home will serve a family earning 60-80 percent of the area's median income. During the pre-development stage, CDS and the Town of Blacksburg sponsored several community design meetings to solicit input from the neighborhood's residents. The final project plans reflected community feedback.

Green Features:

In addition to an affordable purchase price, each home will provide ongoing affordability through the incorporation of energy conserving and healthy indoor environment construction throughout the home. Each home is at least 30 percent more energy efficient than conventional homes, saving residents hundreds of dollars a year in utility bills. The sustainable features include:

- advanced framing techniques and cellulose insulation
- fiber cement siding
- low VOC paints and finishes
- water saving two flush toilets
- high efficiency windows and heat pumps
- Energy Star® appliances
- certified wood flooring
- rain water capturing systems
- landscape features including rain gardens and native landscaping
- porous pavers

